

HOW TO USE YOUR SWING CAR

Congratulations on the purchase of your Swing Car, the easy to operate, kid-powered, ultimate ride-on toy. Before the Swing Car is put to use, make sure to read and follow all assembly, operating, and safety instructions. The Swing Car is designed to accommodate anyone from a three-year old child to an average sized adult, and is manufactured for hours upon hours of smooth gliding.

How to Use the Swing Car

Sit on top of the Swing Car with both feet placed on the footrests and both hands on the steering wheel.

Turn the wheel back and forth continuously, and the Swing Car's unique design will use gravity and centrifugal force to glide forward on its own. To stop, simply stop turning the steering wheel, wait for the car to slow, and place feet on the ground.

To move faster, lean slightly forward over the steering wheel and use your whole upper body when you turn the steering wheel (not just your arms).

The maximum speed on smooth level ground should be approximately 6 miles per hour (although normal operation yields speeds of 3-4 miles per hour).

Where to Use the Swing Car

The Swing Car works best when used on smooth, flat surfaces such as interior wooden, tiled or linoleum covered floors or exterior concrete, paved paths, asphalt, and other open areas.

Ideal for use in any area with a smooth, flat surface and plenty of room to operate.

What the Swing Car is Made of

The Swing Car's parts include PP, ABS, Nylon and stainless steel fittings for the wheels and other moving parts. The Swing Car requires no batteries or power sources of any kind, except the rider.

What the Swing Car can Support

The maximum weight of the pilot of the Swing Car shouldn't exceed 230 pounds (16.4 stone; 105 kg)

On certain surfaces, lower passenger weights are recommended to ensure the safety of the pilot and the lifespan of the Swing Car. The following are recommended weight limits for different surfaces:

- Concrete, paved & asphalt surfaces outdoors – 130 pounds (9.3 stone; 59 kg)
- Wooden, tiled and other surfaces inside – 200 pounds (14.3 stone; 91 kg)
- Polished concrete surfaces – 230 pounds (16.4 stone; 105 kg)

Safety Precautions

Despite the Swing Car's durability and safety standard-approved design, make sure to always remember:

- All children pilots, especially those under the age of 5, should be supervised by an adult whenever the Swing Car is being operated
- The Swing Car should not be used on any public street or thoroughfare, near any kind of traffic, or anywhere else cars, buses, motor bikes, and other vehicles operate
- The Swing Car should not be used near pools, steps, or other drop-offs
- The Swing Car should not be ridden or raced on steep slopes or uneven and rough surfaces
- The Swing Car pilot should always sit on the seating area facing forwards
- The Pilot should sit close to the steering wheel, rather than the back of the Swing Car, to maximize control and remove any possible risk of falling or tipping backwards
- **Failure to observe the above warnings, or the use of the Swing Car in any way other than that intended, could cause serious injury or death.**

Made in China

ASSEMBLY INSTRUCTIONS

Read and follow these instructions for proper assembly of the Swing Car.

Parts List (verify that all pieces are included prior to beginning assembly)

- 1) Car Body including seat and foot rests (1)
- 2) Rear Wheel Assembly (2)
- 3) Front Wheel & Steering Rod Assembly (1)
- 4) Protective Steering Rod Foam Sheath (1)
- 5) Steering Wheel (1)
- 6) Steering Wheel Cap (1)
- 7) Assembly Tool (1)
(Hex Key)

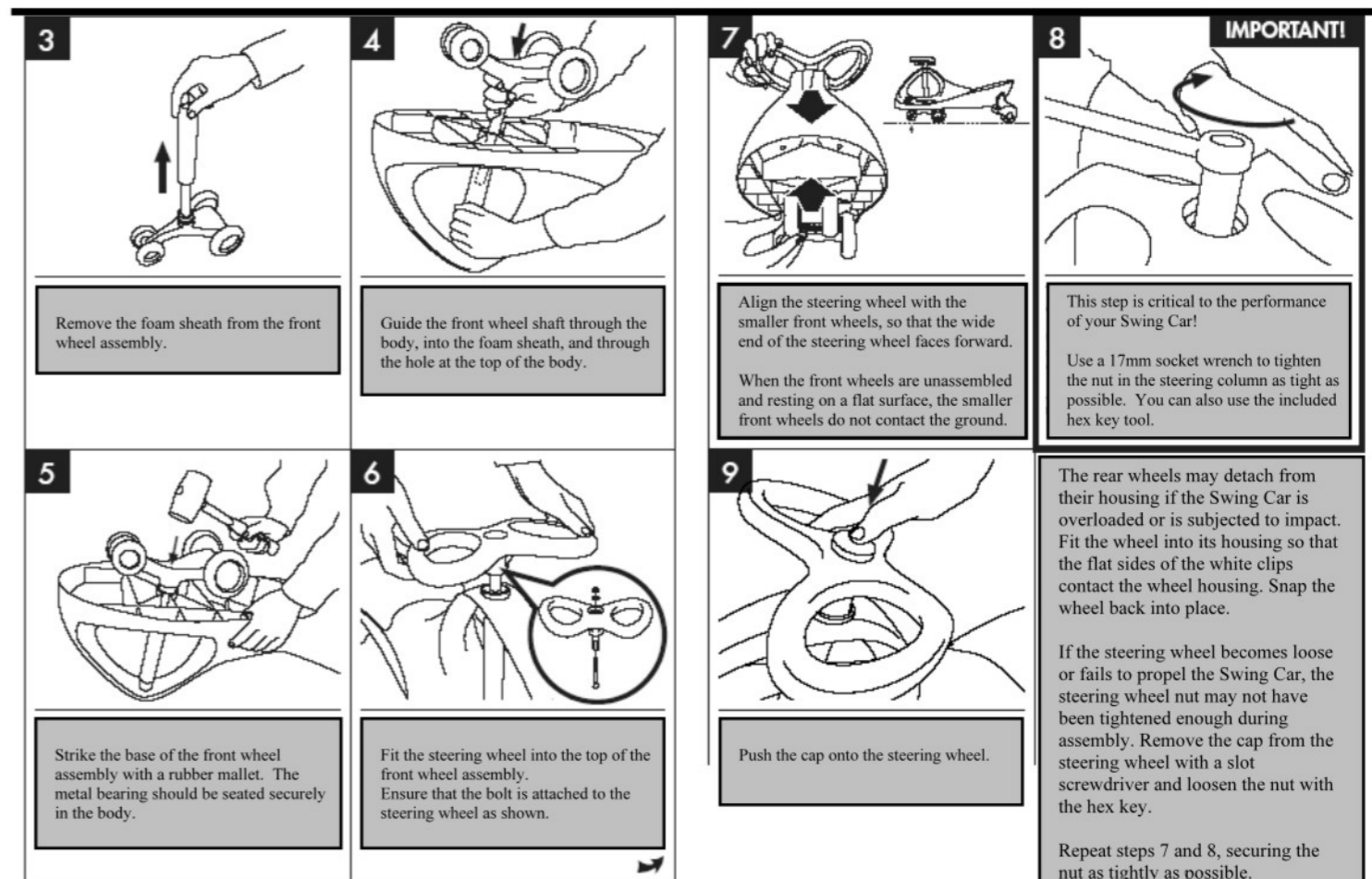
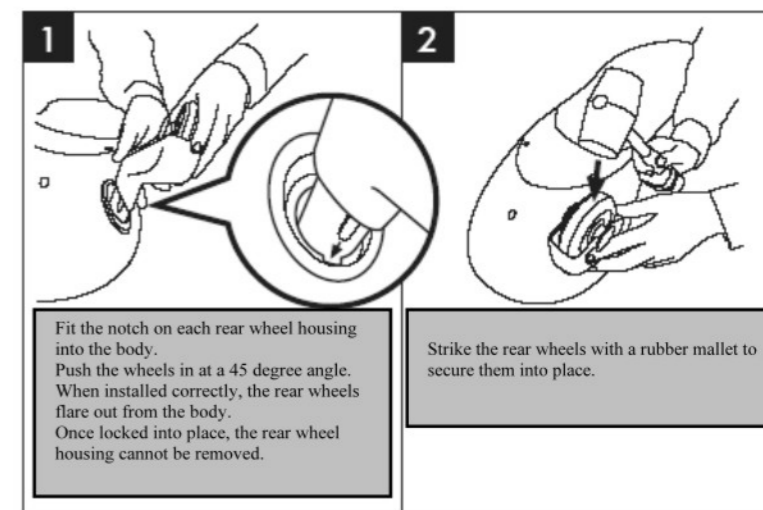

WARNING: Contains small parts, not suitable for children under 3 years old.